



Proposed Building of **ROTARY SAMAJ SEVA KENDRA,** Kolhapur



ROTARY SAMAJ SEVA KENDRA

BOARD OF DIRECTORS :

- **Rtn. V. N. Deshpande**
President
- **Rtn. Subhash Malu**
Secretary
- **Rtn. Avinash Raste**
Treasurer

MEMBERS :

- **Rtn. Rampratap Zanvar**
- **Rtn. Arvindkumar Ruia**
- **Rtn. Narayan Patel**
- **Rtn. Mohan Patel**
- **Rtn. Dr. Mandar Patil**
- **Rtn. Mahendra Parmar**
- **Rtn. Upendra Deuskar**
- **Rtn. Pratap Puranik**
- **Rtn. Rajendra Deshinge**
- **Rtn. Suresh Gulavani**
- **Rtn. Rajiv Parikh**
- **Rtn. Hemant Kulkarni**
- **Rtn. Sanjeev Chiplunkar**
- **Rtn. Tushar Kamat**
- **Rtn. Gajendra Vasa**
- **Rtn. Govind Gundesha**
- **Rtn. Harishchandra Sharma**
- **Rtn. Bhupendra Shah**
- **Rtn. Adv. Ramesh Hirve**
- **Rtn. Girish Karnawat**
- **Rtn. Pradeep Karande**

EX-OFFICIO :

- **Rtn. Subhash Kutte**
President,
Rotary Club of Kolhapur
- **Rtn. Bharat Kharate**
Secretary,
Rotary Club of Kolhapur
- **Rtn. Arvind Krishnan**
Community Service Director,
Rotary Club of Kolhapur
- **Mrs. Sucheta Korgaonkar**
Korgaonkar Trust

ROTARY CLUB OF KOLHAPUR

The Rotary Club of Kolhapur was sponsored by Rotary Club of Solapur in the year 1943. The founder President of the club was Rao Bahadur Rtn. S. A. Indulkar and the Founder Secretary was Rtn. D. V. Tengshe. The club had sixty charter members to begin with. The club made steady progress since then and has produced many District Governors – viz. Rtn. S. G. Dabholkar, Rtn S.M.Ghatge, Rtn Motibhai Doshi, Rtn Dr Sunil Desai and Rtn Pratap Puranik.

The club has so far contributed US \$ 274 thousand to Rotary Foundation, which is the highest contribution in Rotary Dist. 3170. The club is having 15 major donors and 105 PHFs. Today's strength of club is 127. Being the oldest Rotary Club in Kolhapur, administration of the club is very strong. Moreover it has the right mix of experienced and new members. The club has sponsored many clubs in Kolhapur and surrounding areas.

The club has also sponsored St. Xavier's High School (then known as Shanti Vidyalay), Bal Kalyan Sankul and Yoga Vidyadham etc, which are leading institutes in Kolhapur.

ROTARY SAMAJ SEVA KENDRA, KOLHAPUR

Rotary Samaj Seva Kendra, a Charitable Trust sponsored by Rotary Club of Kolhapur was founded in April 1969 in order to provide paramedical services to the community, especially the amenities which were not available in Kolhapur. The other objects were helping the physically handicapped people and promoting social and educational development of the community.

Late Shri. Prabhakar pant Govindrao Korgaonkar, a noted philanthropist on behalf of the Korgaonkar Trust donated a plot of land to this trust in 1970 and Foundation Stone of this Community Service Centre laid by Late Nawab Ali Yawar Jung, then Governor of Maharashtra on 28th May 1970. The building was inaugurated by then District Governor late Rtn. Nahani T. Kapadia, in 27th June 1972.

Rotary Samaj Seva Kendra now runs Rajarshree Shahu Blood Bank, Physiotherapy center, Ear and Speech Institute, Deaf Nursery, Sickbed service, Nana-Nani Park, Rotary Bal Mandir, V.S Khandekar School etc. Almost 50,000 needy persons are served every year through these centers.

But the present building which is almost 50 years old now needs to be demolished and a new building has to be constructed. We have therefore planned to construct a new modern Building having 2 floors of parking and 4 floors of project space. Total Built-up area will be 25,000 sq. ft. This will enhance the capacity of all our existing projects and serve the community better.

Rotary Physiotherapy Centre

■ Existing Facilities, Area 1600 sq.ft.



- **Establishment** : 1975 (Only one Institute in Kolhapur District)
- **Facilities** : Advance equipments, Special attendance of Physiotherapist to every patient, Doubt clearance of every patient, Advance technics by Physiotherapist, 35 Types of treatments are available, Patients type : Paralysis, Polio, Fractures, Accidents Spondylosis etc. The above facilities given at nominal charges.
- **Instruments** : S.W.D. Ultrasonic, Galvanic and Faradic stimulation various Traction, wax bath and different kinds of exercise material
- **Patient Treated Daily Approx.** : 80-100
- **Benefitted patients Approx.** : 2000+ per month
- **Well trained Physiotherapist & Technical Staff**



PROPOSED GROUND FLOOR



ROTARY PHYSIOTHERAPY CENTRE

■ Area 4135 sq.ft.

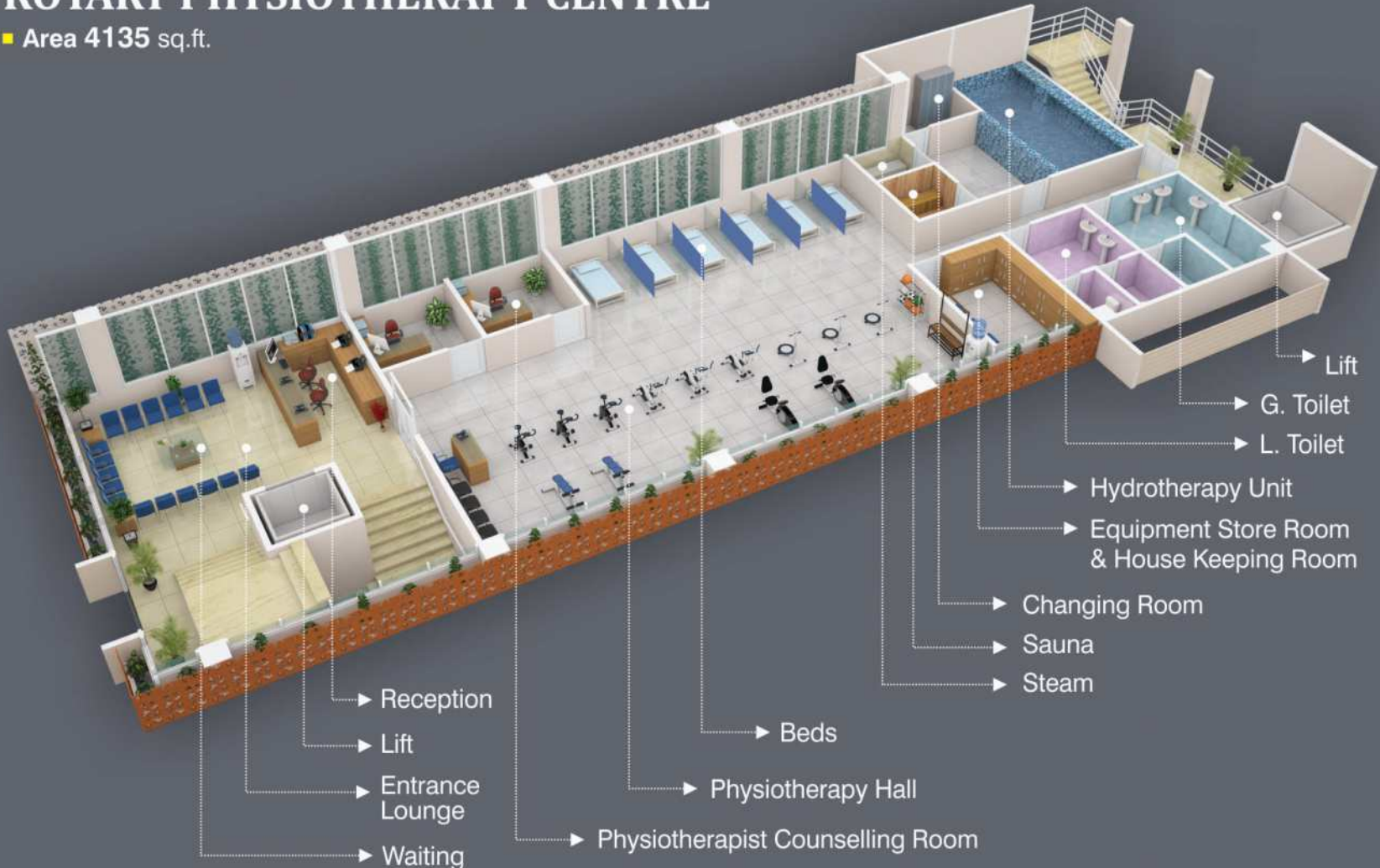

Rotary Institute of Speech & Hearing

■ Existing Facilities, Area 125 sq.ft.



- **Establishment** : 1980
- **Facilities** : Low rates, Advance equipments for Hearing Evaluation, Speech Therapy, Hearing and Repair, Earmold facilitation, Hearing Aids trial fitting, BERA & ENG testing, Newborn hearing screening test, All types of Hearing aid available.
- **Impedance** ■ **Supplied Hearing Aids with earmold in suitable size**
- **BERA Test** ■ **Special Test** ■ **ENG Test**
- **Patient Daily Approx.** : 40
- **Cured patients till today** : 1,00,000 +
- **Well Trained Doctors & Technical Staff**



PROPOSED FIRST FLOOR



ROTARY INSTITUTE OF SPEECH & HEARING

■ Area 1855 sq.ft.

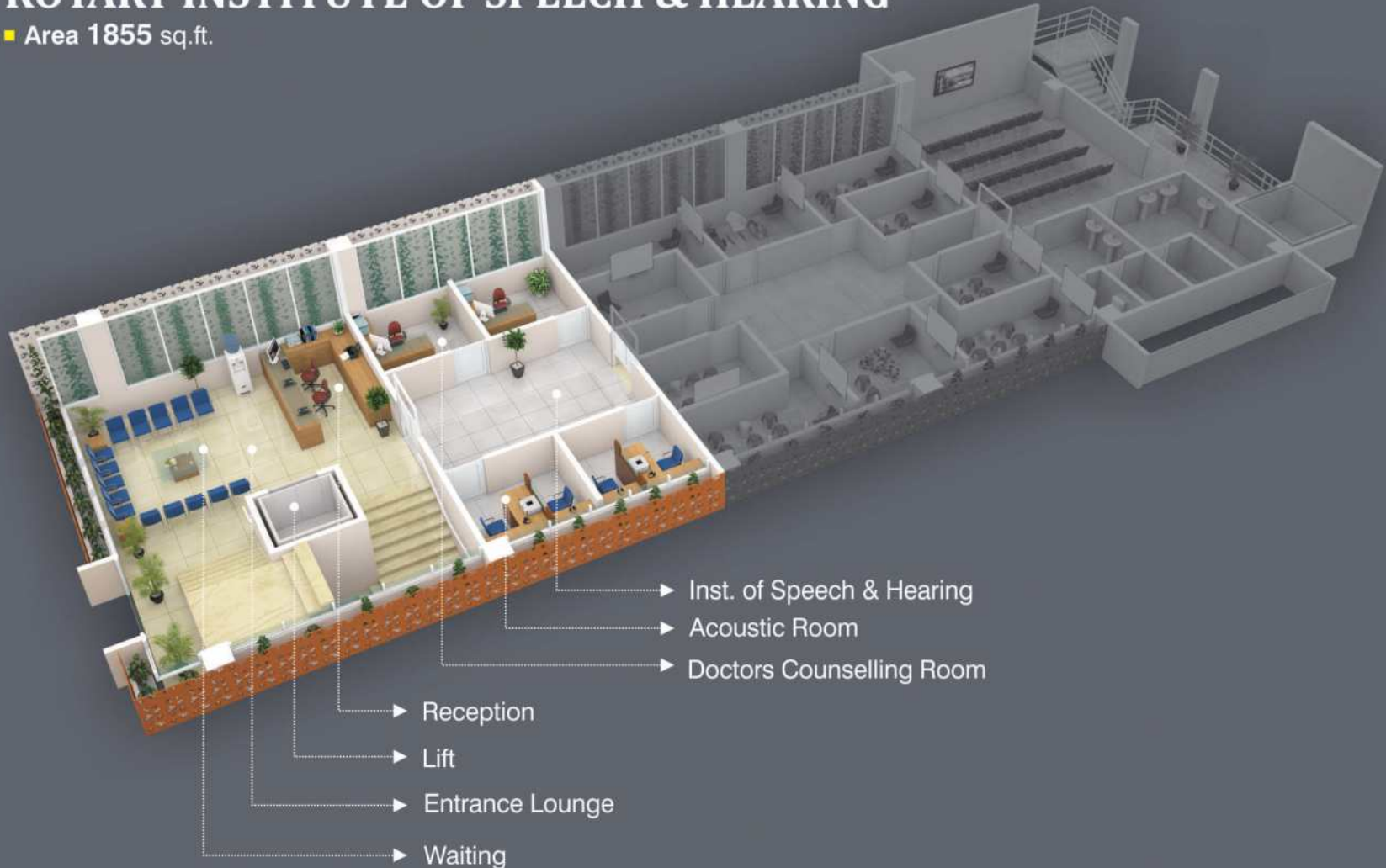

Rotary Karna Badhir Shishu Vidyalay

■ Existing Facilities, Area 1500 sq.ft.



- **Establishment** : 1980
- **Facilities** : Early Detection & Early Intervention, The tests for hearing impairment like OAE, BERA, PTA are available, Suitable Hearing Aids in Low Rates, Guidance & Counselling for parents, Aim to develop language skills & giving speech therapy, Training the children upto 6 years of age by specially trained teacher to join regular School, Well equipped class rooms
- **Activities** : Gathering, Picnics, Medical Checkup Camp, Donors Gratitude ceremony
- **Total strength of the students** : 50-55 every year
- **Educated students till today** : 1500+
- **Well Educated & Trained Technical Staff**



PROPOSED FIRST FLOOR



ROTARY KARNA BADHIR SHISHU VIDYALAY

■ Area 2280 sq.ft.

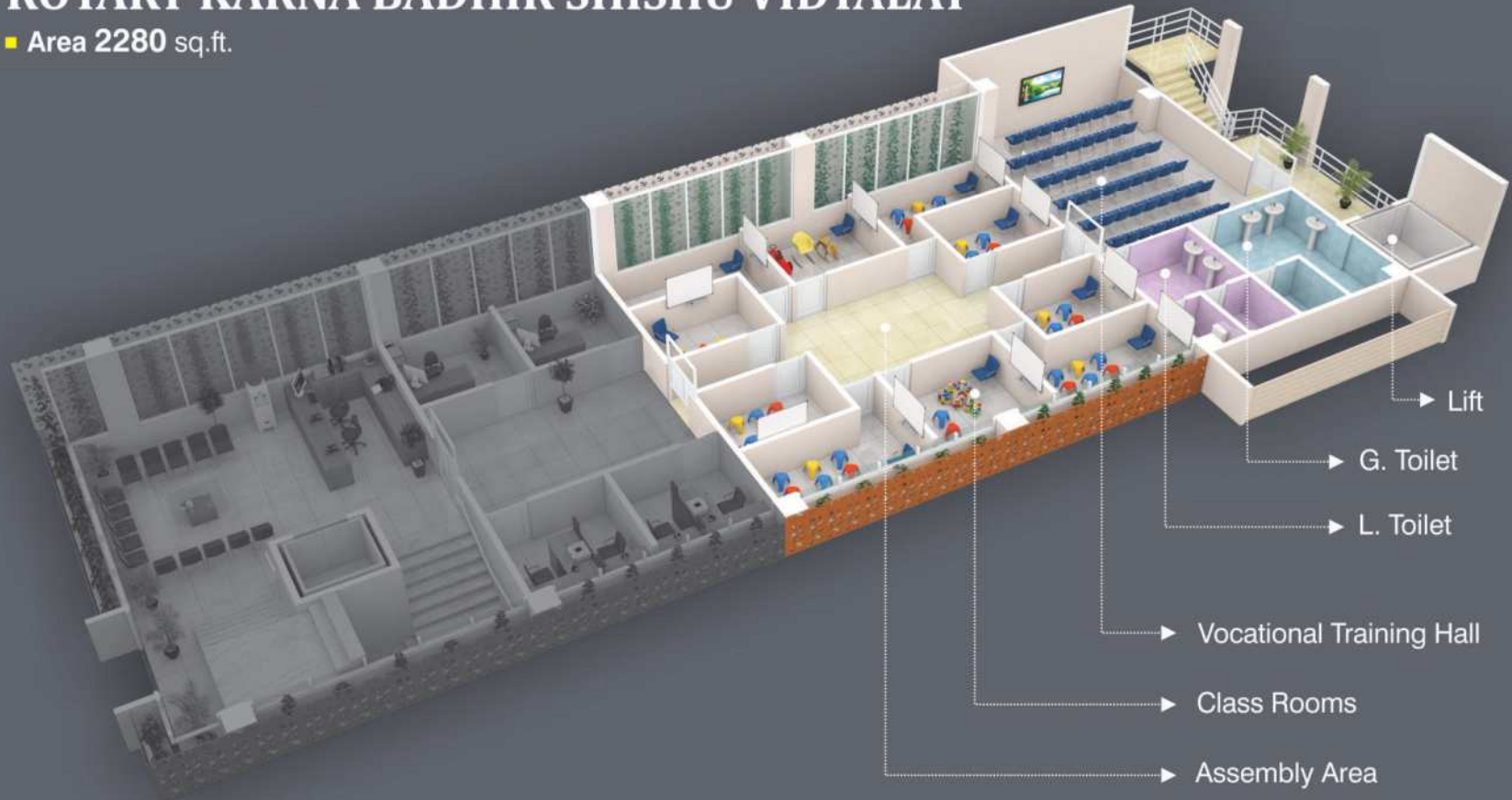

Rajarshi Shahu Blood Bank

■ Existing Facilities, Area 2100 sq.ft.



- **Establishment** : 1975 (Largest Blood Bank in Western Maharashtra)
- **Facilities** : Component Separation Unit : Providing Packed Cells, 24 Hours plan, Chemiluminescent immunoassay analyzer for testing blood & Blood Products, Random Donor Platelets, Fresh Frozen Plasma and Cryoprecipitate, Aphaeresis Unit: Providing Single Donor Platelets. Fully equipped Component & Aphaeresis Lab. Automation in Blood Grouping with Gel Technology.
- **Features** : Providing uninterrupted service since, Collecting more than 10000 units per year. Conducting 150 camps in and around Kolhapur, Promoting only Voluntary Blood Donation.
- **Well trained Doctors & Technical Staff**



PROPOSED SECOND FLOOR



RAJARSHI SHAHU BLOOD BANK

■ Area 4135 sq.ft.



PROPOSED THIRD FLOOR



ROTARY HALL

- Area 4135 sq.ft.
- Sitting Capacity - 300



Rotary Pakshirth

Birds Sanctuaries



- **Establishment** : 2015
- **Plot Area** : 2.5 acres
- **Trees planted** : 240 +
- **Storage Tank** : 50 x 60 sq. ft.
- **Few birds seen at Pakshirth** : Black Winged Kite, Weaver Bird, Bee Eater, Peacock, Grey Tit, Red Vataled Lapwing, White Breasted Kingfisher, Purple Rumped Sunbird, Purple Sunbird, Bay Back Shrike, Red Vented Bulbul, House Sparrow, Myna, Bramhiny Kite, Pariah Kite,lark, Indian Robin, Magpie Robin, Fantail Flycather...



Rotary Nana Nani Park



- **Establishment** : 2001
(Rotary club of Kolhapur is taking care of this project from KMC)
- **Plot Area Approx.** : 1 Acre
- **Facilities** : Garden, Walking Track, Newspaper Stall, Open Gym Equipments, Toilet, Hall for Probus club.
- **People Daily Approx.** : 200
- **Activities** : Probus club is taking monthly a meeting on first Sunday of each month, Daily Morning "Hasya Club" for Senior citizens, Various Doctor camps organized for senior citizens.



Rotary Balmandir & V. S. Khandekar School & Balmandir



- **Establishment** : 1993 & (V. S. Khandekar School) 2014
- **We provide** : Education only for slum area children, Free Education & Indian Culture Knowledge, 100% support & Maintenance by Rotary Members, Uniform & Bags, Educational Material
- **Strength of Students** : 40 & (V. S. Khandekar School) 135
- **Activities** : Gathering, Celebrating every festivals, Extra Curricular activities



PROPOSED STILT FLOOR PLAN

■ Area 4050 sq.ft.

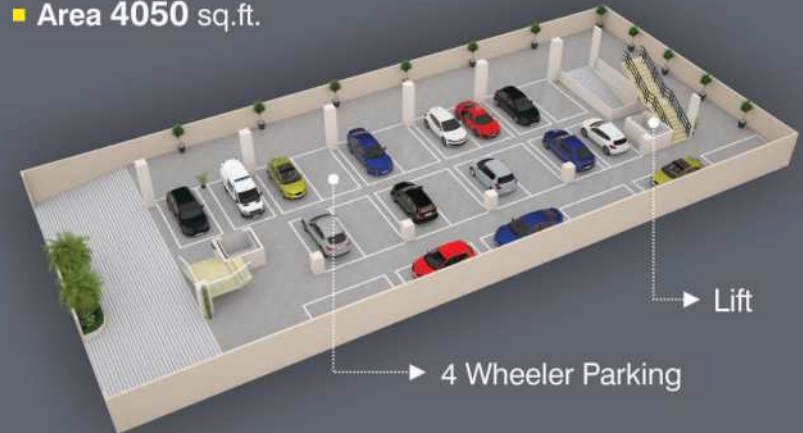

PROPOSED BASEMENT FLOOR PLAN

■ Area 4050 sq.ft.



Donation Chart

Rotary Samaj Seva Kendra is soliciting donations for this New Building Project.
The **names of Donors** will be displayed at the reception area on the boards as under -

**PLATINUM
Donors**

**Rs. 10 Lacs
& above**

**GOLD
Donors**

**Rs. 5 Lacs
& above**

**SILVER
Donors**

**Rs. 1 Lacs
& above**

**Proposed
Building Area
25,000 sq.ft.**



* Exemption U S 80G of the Income Tax Act 1961

D.D. / At par Cheque to be issued in the name of **“ROTARY SAMAJ SEVA KENDRA”** payable at Kolhapur

Details for Payment :

A/c. Name : ROTARY SAMAJ SEVA KENDRA
Bank Name : Bank of Borada
Branch : Shahupuri Br., Kolhapur
Customer ID : 050323536
Account No. : 04350100007685
IFSC Code : BARB0SHAHUP (Fifth Character is zero)
MICR Code : 416012003

Additional information

Contact :

Rtn. Subhash Malu

Secretary, RSSK, Kolhapur

Cell : +91-9422414242

Rotary 



Indrajit and Rupa Nageshkar, Architects,
Engineers and Urban Designers - 9822070380

ROTARY SAMAJ SEVA KENDRA

Near Collector Office, Kolhapur - 416001. Maharashtra. India.

Phone : **+91-231-2651444**, Email : rsskkop@gmail.com